

USGBoral Joint Tapes

For the seamless jointing of Gypsum Boards

USG Boral Metal Corner Tape



Metal Corner Tape

Dimensions - 50mm x 30.88m

Product Description - This is a paper tape with galvanized steel strips designed effectively to protect corners

Features

- Excellent for working curves, arches and unusual angles
- Easy to apply and store
- Cost effective as compared to edge beads, angle beads
- Excellent adhesion with compound & paint
- High quality paper with laser perforation for good air permeability

Application procedures for Metal Corner Tape



- 1 Cut the tape
- 2 Bed the tape on both sides



- 3 Apply 50mm wide layer of Jointing Compound on both sides
- 4 Remove excess compound using taping knife

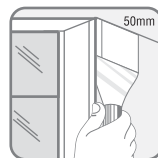

- 5 Apply a further 50mm Jointing Compound beyond the edges of first coat



- 6 Wide, galvanized steel strips act as a guide to ensure straight, reinforced angles for both "inside" and "outside" corner needs

